

Lancer Bloc

Durbanis
2008

Sizes in cm

Material: Concrete bench colored in mass.

Weight: Lancer Bloc 45, 170kg. / Lancer Bloc 60, 360kg. / Lancer bloc 120, 400kg. / Lancer Bloc 240, 1.200kg. / Lancer Bloc 240 1B, 1.850kg. / Lancer Bloc 240 2B, 2.200kg.

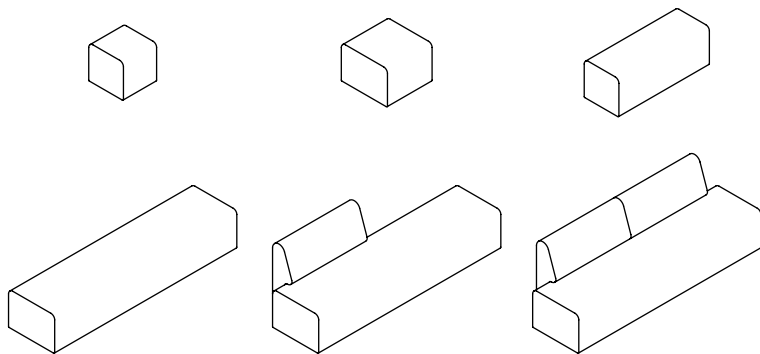

Placement system

Handling with long polyester slings. The installation consists of simply supporting it on the ground. All models have M12 threaded bolts at the base, to screw M12 bars and embed them into pavement, in case of needing an extra fixation.

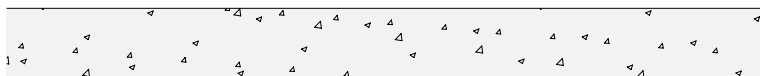
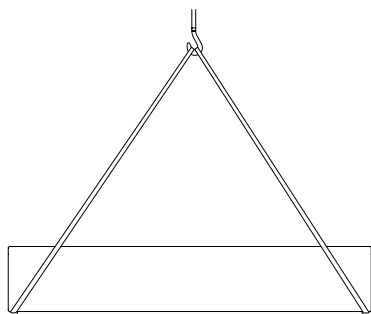

LANCER BLOC 45

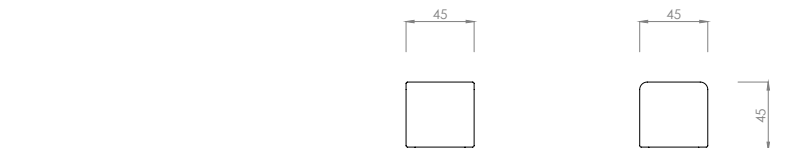

LANCER BLOC 60

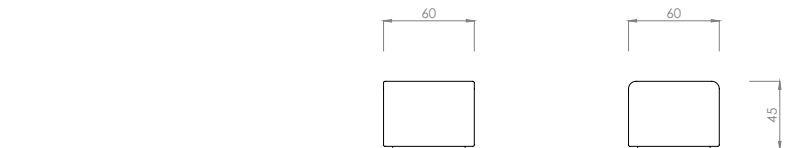

LANCER BLOC 120

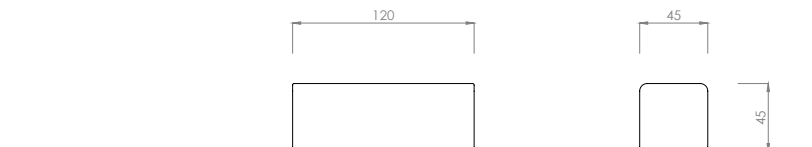

LANCER BLOC 240

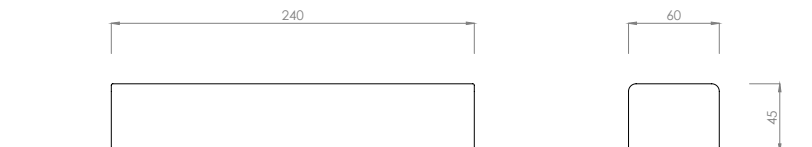

LANCER BLOC 240 1B

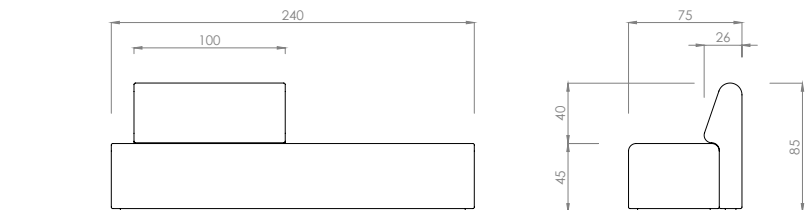

LANCER BLOC 240 2B

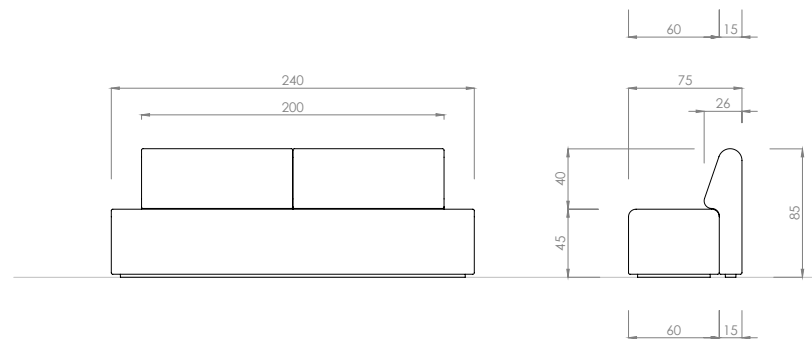

Lancer Bloc R

Durbanis
2025

durbanis

Sizes in cm

Material: Concrete bench colored in mass.

Weight: Lancer Bloc R200, 1.700kg.

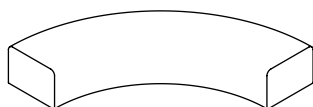

Placement system

Handling with long polyester slings. The installation consists of simply supporting it on the ground. All models have M12 threaded bolts at the base, to screw M12 bars and embed them into pavement, in case of needing an extra fixation.

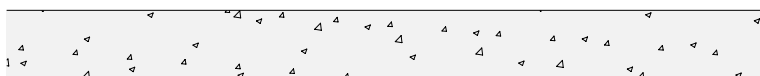
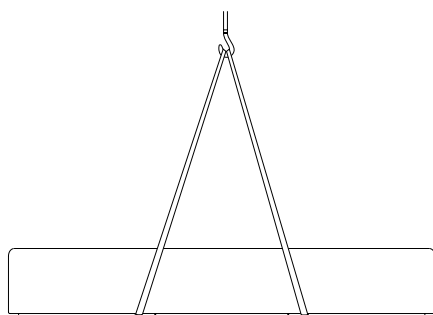

LANCER BLOC R200

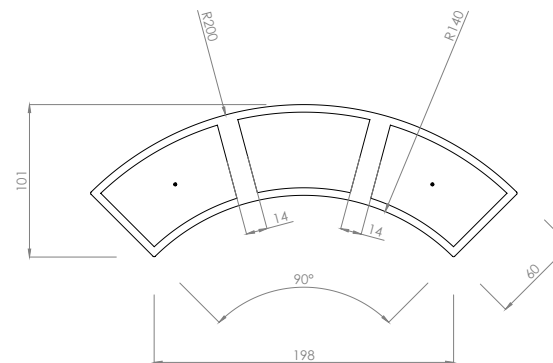

BOTTOM

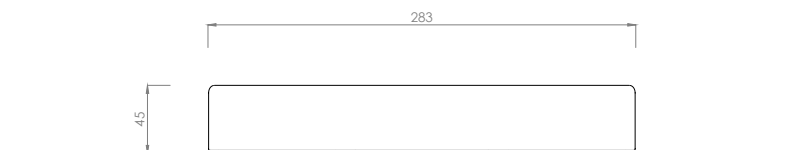

FRONT

POSSIBLE CONFIGURATION

