

Installation systems
Sistemas de instalación
Systemes d'installation

Halong

MOUNTING INSTRUCTIONS

durbanis

Surface fixing

Fijación a superficie

Fixation à la surface

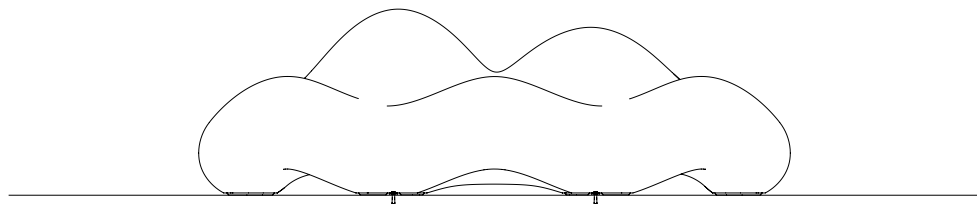

1

Fix the metal bracket (A) to Halong with the supplied M8x15 screws.

Fijar pletina metálica (A) al Halong usando los tornillos M8x15 que se suministran.

Fixer la bride métallique (A) au Halong avec les vis M8x15 fournies.

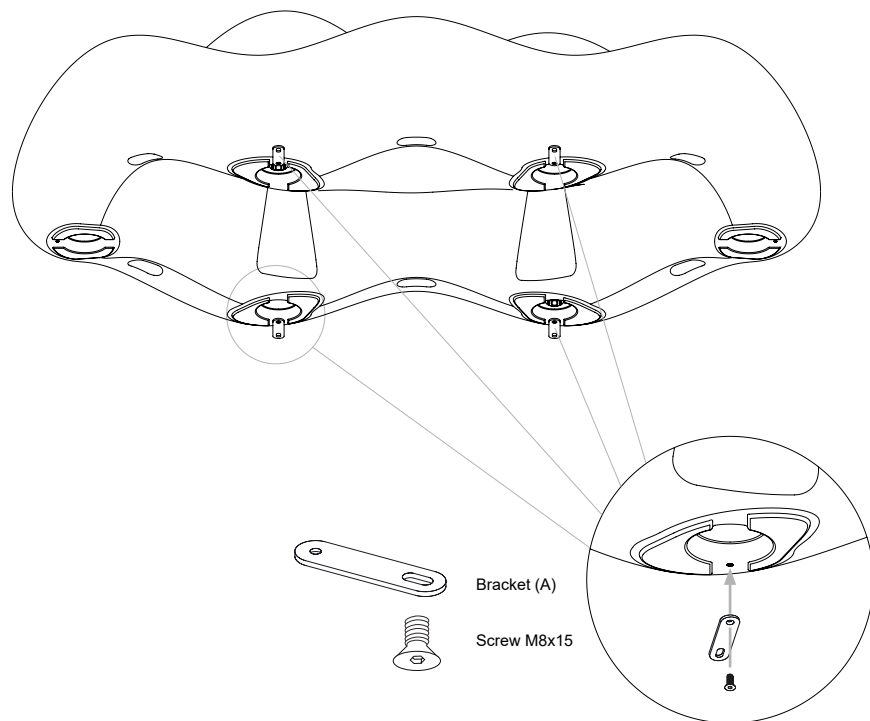

2

Turn the Halong upside down and place it in the right place.

Voltear el Halong y colocarlo en el lugar adecuado.

Retourner le Halong et placez-le au bon endroit.

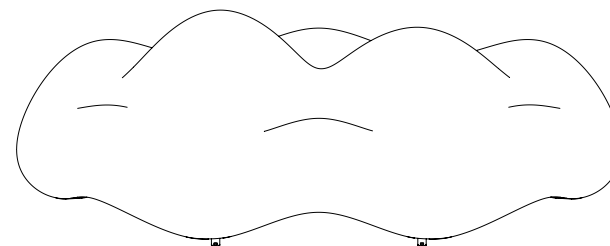

3

Fix the metal bracket (A) to the ground with the suitable rawplug to the ground and the screws supplied.

Fijar la pletina metálica (A) en el suelo con los tornillos suministrados y el taco adecuado al tipo de terreno.

Fixer la bride métallique (A) au sol avec une cheville appropriée au type de sol et les vis fournies.

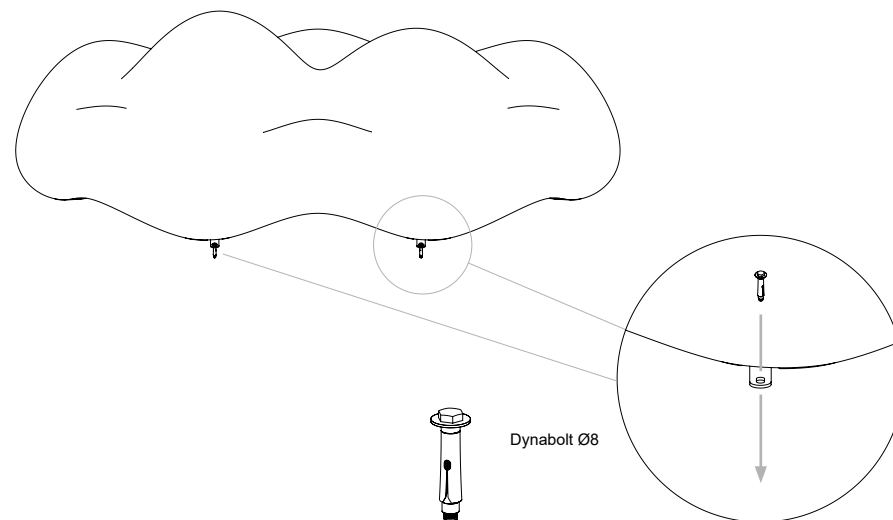

Halong

MOUNTING INSTRUCTIONS

durbanis

Ground fixing

Fijación al suelo

Fixation au sol

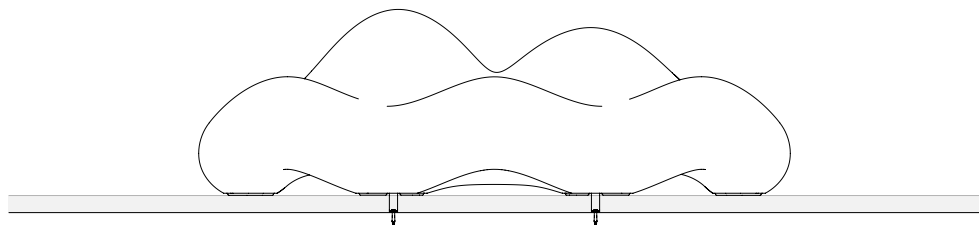

1

Fix the metal bracket (B) to Halong with the supplied M8x15 screws.

Fijar pletina metálica (B) al Halong usando los tornillos M8x15 que se suministran.

Fixer la bride métallique (B) au Halong avec les vis M8x15 fournies.

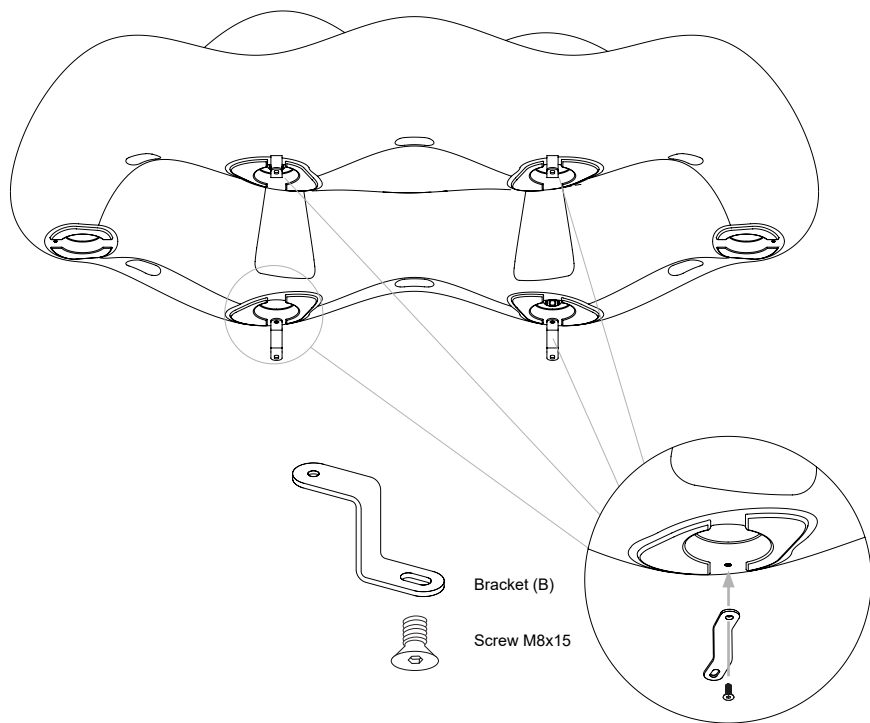

2

Turn the Halong upside down and place it in the right place.

Voltear el Halong y colocarlo en el lugar adecuado.

Retourner le Halong et placez-le au bon endroit.

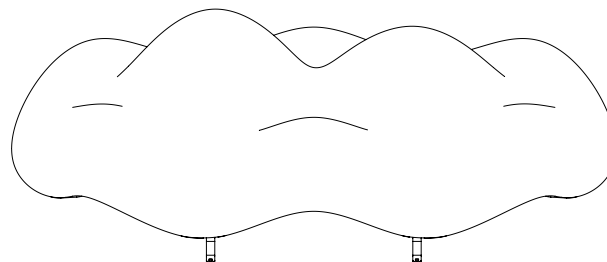

3

Fix the metal bracket (B) to the ground with the suitable rawplug to the ground and the screws supplied.

Fijar la pletina metálica (B) en el suelo con los tornillos suministrados y el taco adecuado al tipo de terreno.

Fixer la bride métallique (B) au sol avec une cheville appropriée au type de sol et les vis fournies.

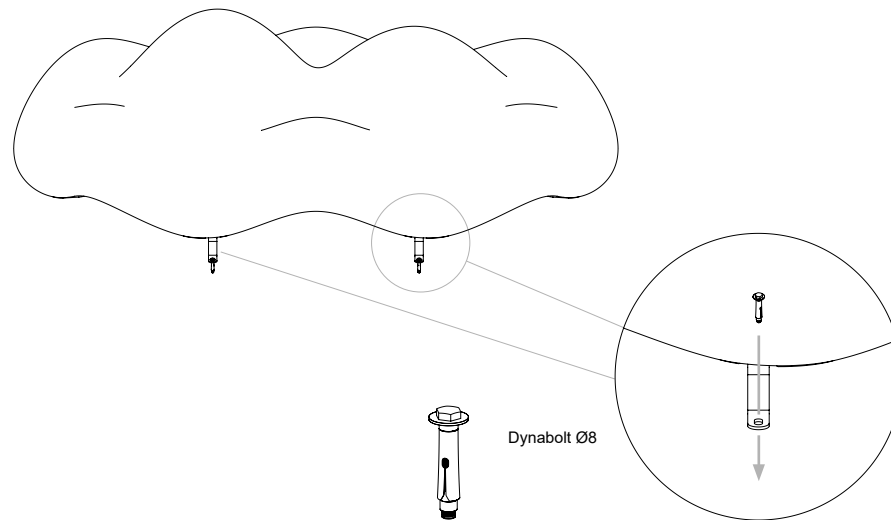

Halong

MOUNTING INSTRUCTIONS

Installation by filling with water or sand

Instalación mediante llenado de agua o arena

Installation en remplissant d'eau ou de sable

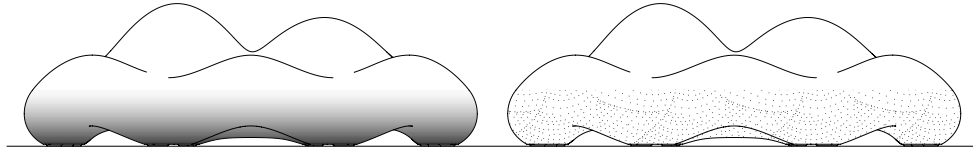

1

Turn the Halong upside down and unscrew the access cap.

Voltear el Halong boca abajo y desenroscar el tapón de acceso.

Retournez le Halong et dévissez le capuchon d'accès.

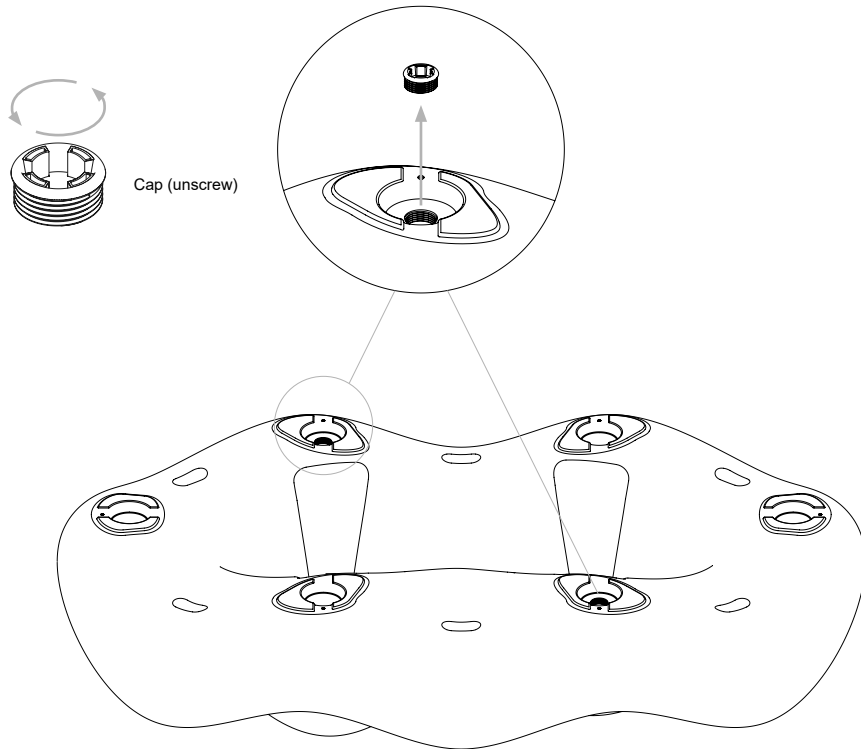

2

Fill the inside of the Halong with 150L of water or 150kg of sand.

Llenar el interior del Halong mediante 150L de agua o 150kg de arena.

Remplissez l'intérieur du Halong avec 150 L d'eau ou 150 kg de sable.

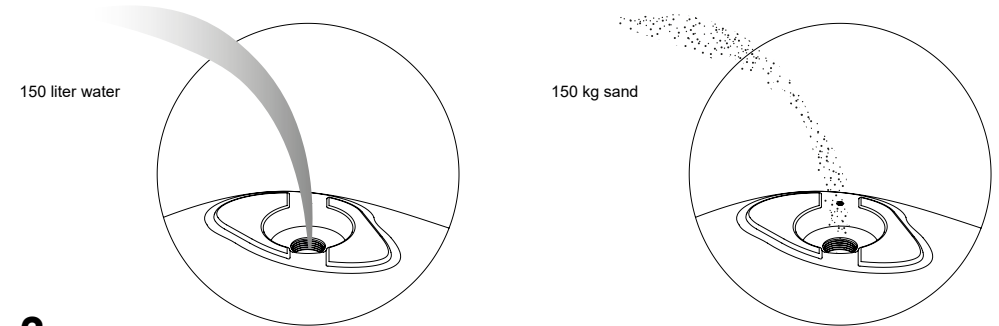

3

Screw on the cap and turn the Halong over again to place it in the right place.

Enroscar el tapón y voltear nuevamente el Halong para emplazarlo en su lugar.

Revissez le capuchon et retournez le Halong pour le placer au bon endroit.

